



# **MINITUBE, MINIVENT & RING PLATE**

**INSTALLATION & MAINTENANCE  
INSTRUCTIONS**



# INSTALLATION & MAINTENANCE INSTRUCTIONS

1. Check fan for possibility of transit damage.
2. Ensure that the duct is clear of any debris that could be drawn into the fan impeller.
3. Check the fan is free to rotate.
4. Wiring diagrams are provided on all fans.
5. Fans 202 to 356 have automatic self resetting thermal cut-out switches incorporated in the motor as standard. Except for the Minitube range which are fitted with a manual reset thermal overload device.
6. All fans are provided with sealed-for-life bearings and are virtually maintenance free.
7. Connections, cables and cords must be installed in accordance with local regulations. This product must be installed by a licensed Electrician.
8. The Licensed Electrical installer must ensure that an approved means of disconnection be incorporated into the fixed wiring.
9. This appliance is not intended for use by young children or infirm persons unless they have been adequately supervised to ensure that they can use it safely. Young children should be supervised to ensure that they do not play with the appliance.
10. For duct or partition mount, precautions must be taken to avoid the back-flow of gases into the room from the open flue of gas or other open-fire appliances.
11. The Minitube range of duct fans must be fitted with a minimum of 1m of duct to both inlet and outlet spigots.
12. After starting check:-  
For excessive vibration  
Full load Amps and ensure they do not exceed the nameplate Amps.
13. Warranty:-  
Fantech Pty Ltd warrants products of its manufacture when not misused or neglected to be free of defects in workmanship and/or materials. Our obligation under this warranty is limited to repairing or exchanging F.O.B. factory, any part, assembly or portion found to be defective within one year from the date of commissioning but not to exceed eighteen (18) months from date of shipment from our factory.  
The Company assumes no responsibility for labour costs involved in the removal of defective parts, installation of new parts or related service charges. The Company shall have the option of requiring the return of the defective part (transportation prepaid by the Buyer) to establish the claim.  
Warranty will be void if installation is not carried out by qualified personnel in accordance with these instructions and good trade practice.  
Fully detailed warranty conditions are contained in Fantech's Standard Conditions of Trading.

## MINIVENT ROOF UNITS - MODELS MV112 - MV356



All Minivent axial roof units can be mounted directly onto roofs pitched up to 30°.

On the MV200, MV250 and MV300 series fans the top cap must be removed to access the electrical junction box.

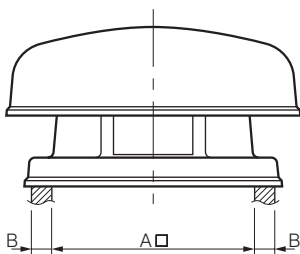

Fan Model	A□	B	Fan Model	A□	B
<b>MV112</b>	210	25	<b>MV204Ex</b>	350	30
<b>MV132</b>	210	25	<b>MV252/4</b>	350	30
<b>MV182Ex</b>	350	30	<b>MV302/4/6</b>	350	30
<b>MV202/4</b>	350	30	<b>MV354/6</b>	400	50

# INSTALLATION & MAINTENANCE INSTRUCTIONS

## INSTALLATION ARRANGEMENTS - MINITUBE

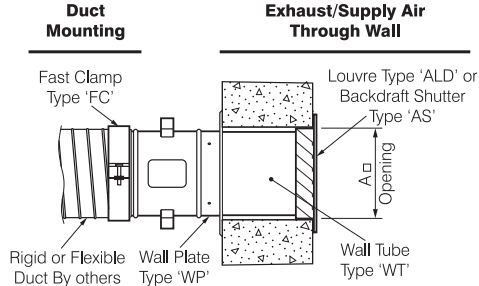

Fan Model	A
<b>MT132</b>	-
<b>MT202/4</b>	210
<b>MT252/4</b>	260
<b>MT302/4/6</b>	310
<b>MT354/6</b>	360

## MINITUBE - VIBRATION ISOLATORS (SUITABLE FOR MT202 TO MT356)

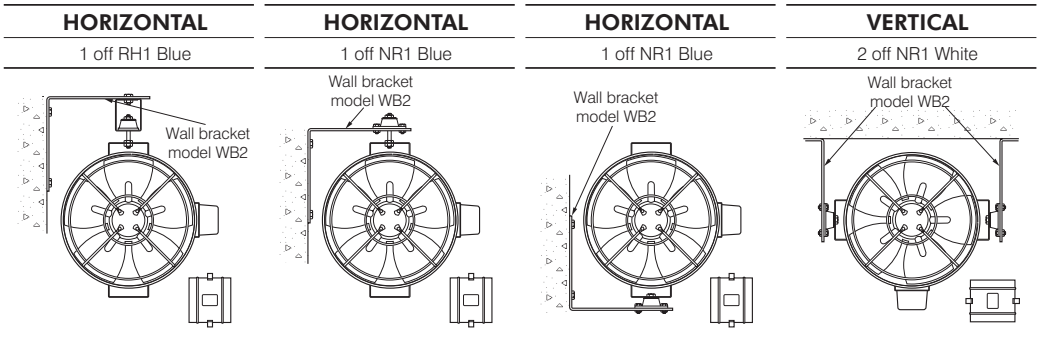

## RING PLATE WALL MOUNTED FANS - MODELS RP202 - RP356

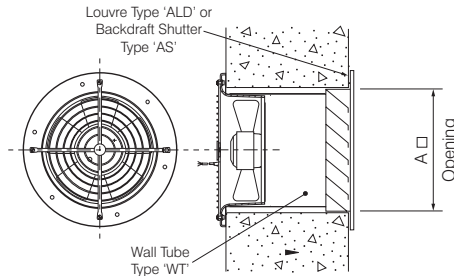

Fan Model	A
<b>RP202/4</b>	215
<b>RP252/4</b>	267
<b>RP302/4/6</b>	318
<b>RP354/6</b>	375

# INSTALLATION & MAINTENANCE WIRING DIAGRAMS

**MT132 & MV132**

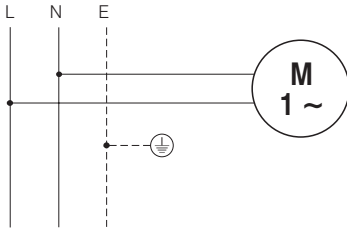

**MT, MV & RP 202 - 356**

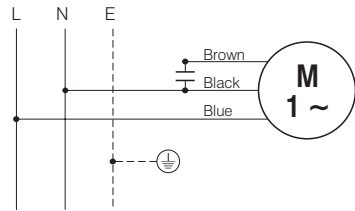

**MV182Ex**

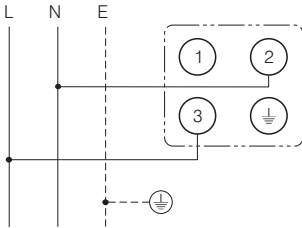

**MV204Ex**

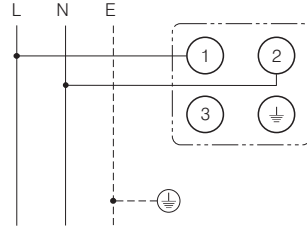

## SPEED CONTROLLERS (SUPPLIED AS OPTIONAL)

**VA2.0 - VARIABLE SPEED**

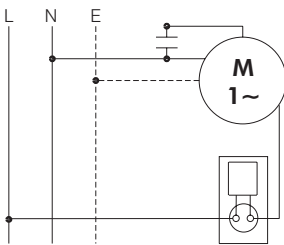

**SSC - 2 SPEED SWITCH**

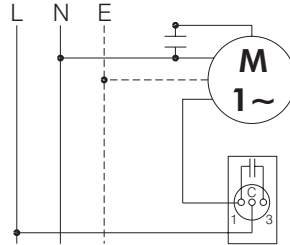

**Head Office:**

Melbourne  
A.B.N. 11 005 434 024  
Ph: (03) 8545 2345  
Fax: (03) 8545 2333

**Australian Offices:**

New South Wales - Sydney:  
Ph: (02) 8811 0400  
New South Wales - Wollongong:  
Ph: (02) 4226 5133  
ACT & Southern NSW:  
Ph: (02) 6280 5511  
Northern NSW - Newcastle:  
Ph: (02) 4961 6088

**South Australia:**

Ph: (08) 8377 0502  
**Western Australia:**  
Ph: (08) 9209 4999  
**Queensland:**  
Ph: (07) 3299 9888  
**North Queensland:**  
Ph: (07) 4775 5222  
**Tasmania:**  
Ph: (03) 6344 6888

**New Zealand Offices:**

**Auckland:**  
Ph: (09) 444 6266  
**Christchurch:**  
Ph: (03) 379 8622

**Wellington:**

Ph: (04) 566 0532  
**International Distributors:**  
**Hong Kong:**  
Ph: (852) 2598 4228  
**Jakarta:**  
Ph: (6221) 5366 1985  
**Kuala Lumpur:**  
Ph: (603) 7803 5504  
**Bangkok:**  
Ph: (662) 316 3428  
**Taipei:**  
Ph: (8862) 8932 1196