

## FGR - FILTER UNIT



### FEATURES

The FGR filter units are fitted with a throw-away panel dust filter. The cassette is made of galvanised steel with rubber-sealed circular connections and the cover has quick-release latches.

Table below indicates which filter fits on specific fan models.

AS1132 No. 4 Test Dust

Average Arrestance - 85.3%

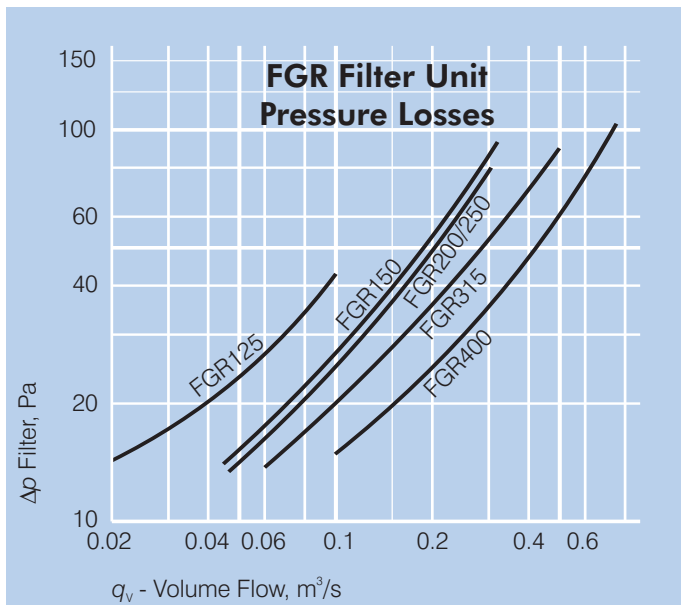

### DIMENSIONS

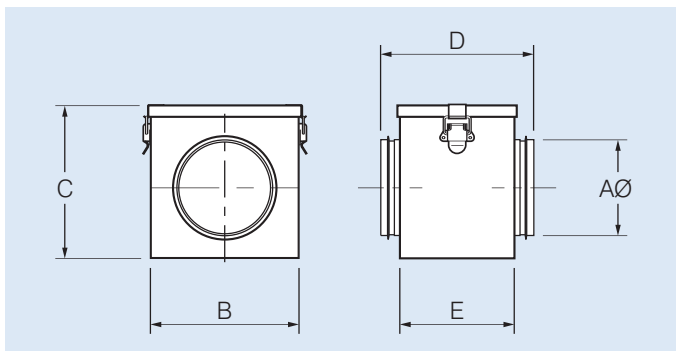

Filter Unit Part No.	Dimensions, mm				
	AØ	B	C	D	E
<b>FGR125</b>	125	200	200	220	122
<b>FGR150</b>	150	200	200	220	122
<b>FGR200</b>	200	245	245	230	122
<b>FGR250</b>	250	295	295	240	122
<b>FGR315</b>	315	345	345	240	122
<b>FGR400</b>	400	448	448	240	150

### SELECTION TABLE

VentMajor In-line Fan Model	Silent EcoWatt MixVent In-line Fan Model	ProVent In-line Fan Model	JetStream In-line Fan Model	Filter Unit Part No.
VM-125L	TD-350/125..	RIL-125	-	<b>FGR125</b>
VM-150L	TD-500/150..	RIL-150SW/RIL-150TSW	JCE152	<b>FGR150</b>
VM-200L	TD-800/200(N)..	RIL-200SW/RIL-200TSW	JCE202	<b>FGR200</b>
VM-250L	TD-1300/250..	-	-	<b>FGR250</b>
VM-315L	TD-2000/315..	-	-	<b>FGR315</b>
-	-	-	-	<b>FGR400</b>

## WALLRODSPK - WALL RODS

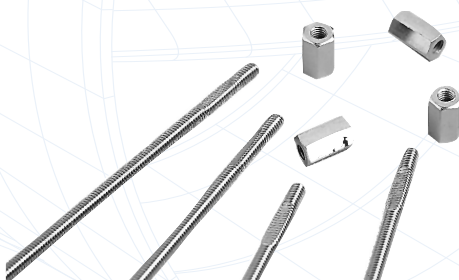

### FEATURES

Used to attach the Stylvent and HCM fans to the wall.

Wall thickness can vary from a minimum of 25mm to a maximum of 300mm. Order in packs of 4.

Part No: WALLRODSPK