

## IC/CIC - INLET CONES FOR AXIAL FANS

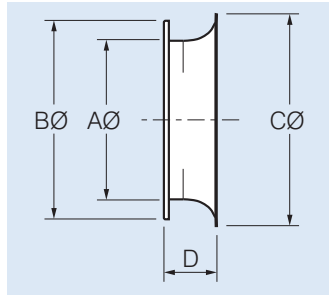

See below for flange drilling detail

### FEATURES

Fantech inlet cones are of an exponential shape which optimises the fans' performance and minimises noise generation.

The inlet cones for axial flow fans are made from galvanised steel. Inlet cones for short case axial fans are made from powder-coated spun steel.

Finger guards are available as an optional extra.

### DIMENSIONS & SELECTION TABLE

#### INLET CONES FOR AXIAL FLOW FANS

Axial Fans Model*	Inlet Cone Part No.	Dimensions, mm			
		AØ	BØ	CØ	D
031.	<b>IC031S</b>	316	383	409	83
040.	<b>IC040S</b>	400	488	505	95
050.	<b>IC050S</b>	501	597	622	109
056.	<b>IC056S</b>	561	659	683	121
063.	<b>IC063S</b>	630	730	805	125
071.	<b>IC071S</b>	722	803	910	154
080.	<b>IC080S</b>	800	885	965	145
100.	<b>IC100S</b>	1000	1110	1190	175
125.	<b>IC125S</b>	1250	1385	1460	205
140.	<b>IC140S</b>	1400	1540	1645	250
160.	<b>IC160S</b>	1600	1750	1900	265
180.	<b>IC180S</b>	1800	1950	2100	295
200.	<b>IC200S</b>	2000	2150	2192	295

\* Suits AP, APS, APB, BFA axial fans and associated attenuators.

#### INLET CONES FOR SHORT CASE AXIAL FANS

Short Case Model	Inlet Cone Part No.	Dimensions, mm			
		AØ	BØ	CØ	D
SC.31.	<b>CIC031S</b>	315	380	410	80
SC.35.	<b>CIC035S</b>	355	425	482	88
SC.40.	<b>CIC040S</b>	400	463	503	95
SC.45.	<b>CIC045S</b>	450	519	600	95
SC.50.	<b>CIC050S</b>	500	567	618	105
SC.56.	<b>CIC056S</b>	560	644	690	115
SC.63.	<b>CIC063S</b>	630	721	805	135

## FLANGE & INLET CONE DRILLING DIMENSIONS

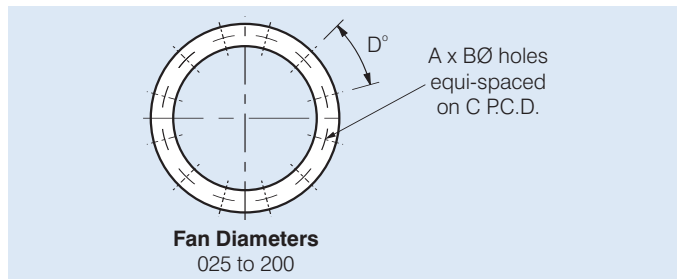

#### SHORT CASE AXIAL & FLAMEPROOF DUCT FANS

Fan Model	A	BØ	C	D deg.
<b>025</b>	8	8	285	45
<b>030</b>	8	8	340	45
<b>031</b>	8	10	356	45
<b>035</b>	8	10	395	45
<b>040</b>	12	10	438	30
<b>045</b>	12	10	487	30
<b>050</b>	12	10	541	30
<b>056</b>	16	10	605	22.5
<b>063</b>	16	10	674	22.5

These dimensions apply to SCD/E and FPMD fans.

#### AXIAL FLOW FANS

Axial Flow Fan Model	A	BØ	C	D deg.
<b>031</b>	8	13	355	45
<b>035</b>	8	13	395	45
<b>040</b>	8	13	450	45
<b>045</b>	8	13	500	45
<b>050</b>	12	13	560	30
<b>056</b>	12	13	620	30
<b>063</b>	12	13	690	30
<b>071</b>	16	13	770	22.5
<b>080</b>	16	13	860	22.5
<b>100</b>	16	13	1070	22.5
<b>125</b>	20	17	1320	18
<b>140</b>	20	17	1470	18
<b>160</b>	24	17	1680	15
<b>180</b>	24	17	1880	15
<b>200</b>	24	17	2080	15

These dimensions apply to AP, APS, APB and BFA fans, inlet cones and associated circular attenuators.